

Thank you for purchasing this Dynojet kit. This kit has been developed for a motorcycle which is set to the parameters listed at the right in the "Stage" description. If your motorcycle does not meet any of these parameters please check with Dynojet before installation. For technical assistance contact your Dynojet distributor or call Dynojet U.S.A. (800)-992-4993

2191 Mendenhall Dr. Suite 105
 North Las Vegas, NV 89031
 TEL: 702-399-1423
 FAX: 702-399-1431
 8am-5pm Pacific Time
 Monday through Friday

Website Address
<http://www.dynojet.com>

The manufacturer and seller make no warranties express or implied which extend beyond the description of the goods contained herein. Any description of this product is for the purpose of identifying it and shall not be deemed to create an express warranty.



4745.001

U.S. Models Only

1997-2003 Yamaha YZF600R

Stage 7 - Race Use Only

For mildly tuned machines using the stock airbox with stock filter. May be used with a good after-market exhaust system. K&N filter # YA-6096

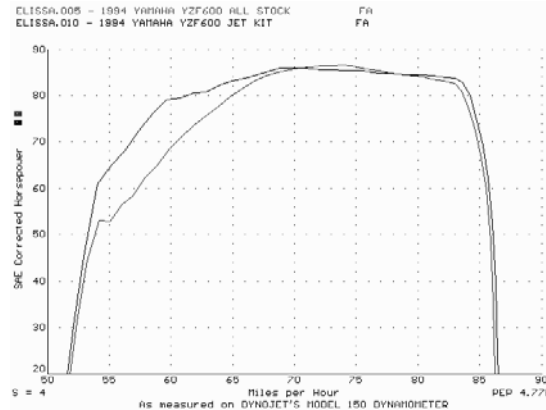

This graph shows a typical gain with a Dynojet jet kit.

WARNING

**NO SMOKING!
 NO OPEN FLAME!
 WHILE INSTALLING
 YOUR DYNOJET KIT**

Parts List

| | | |
|---|-------------------|----------|
| 4 | Main Jets | DJ118 |
| 4 | Main Jets | DJ120 |
| 4 | Main Jets | DJ122 |
| 4 | Main Jets | DJ124 |
| 4 | Fuel Needles | DNO207 |
| 4 | Slide Springs | DSP026 |
| 8 | Adjusting Washers | DW0001 |
| 4 | E-Clips | DE0001 |
| 4 | Main Air Plugs | DCO200 |
| 1 | Tool | DT001 |
| 1 | Plug Drill | DD #5/32 |
| 1 | Screw | DS0001 |

STAGE SEVEN INSTRUCTIONS

1. Remove the vacuum slide from the carbs. Remove the stock needles & spacers, noting the order of assembly.
2. Install the Dynojet needles on groove #3 from the top, using all stock spacers. Install the Dynojet washers (2 for each needle) above the E-clip. Install Dynojet slide springs DSP026.
3. Remove the velocity stack plate and locate the main air jet passage (Fig.B.) With the flat end facing into the carb, install the main air plugs provided (DCO200). Use the tool provided (DT001) tap lightly in place.
4. Remove the stock main jets and replace with Dynojet main jets provided. The base main jet is DJ120. Other main jets are supplied for varying conditions, ie different fuels altitudes etc. Be sure that the jet you are changing is the main jet.
5. Locate the fuel mixture plug (Fig. C), if you see a screw head at Fig. B proceed to adjusting procedure. With the DD #5/32 drill bit provided, carefully drill thru the plugs. Note: the mixture screw is directly underneath this plug, be ready to pull back on the drill the instant you break thru. Use screw provided to secure and remove the plug. Carefully turn mixture screws clockwise until they seat, turn out 2-1/2 turns.

DYNOJET

4745.001

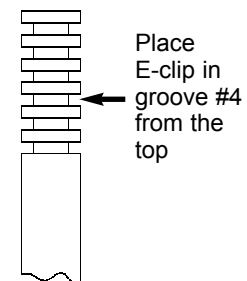

Fig. A

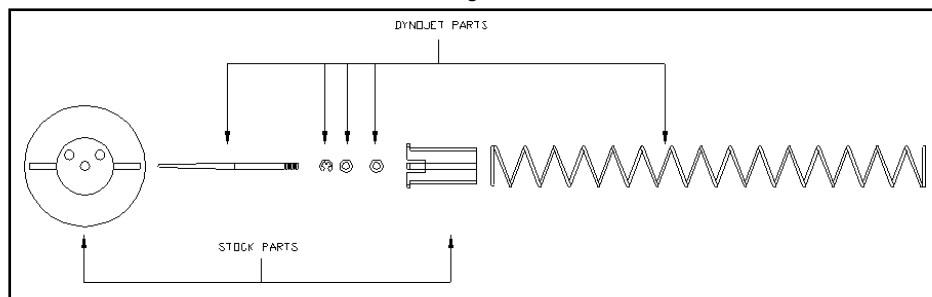

Fig. B

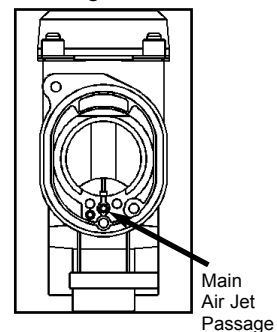

Fig. C

