

Thank you for purchasing this Dynojet kit. This kit has been developed for a motorcycle which is set to the parameters listed at the right in the "Stage" description. If your motorcycle does not meet any of these parameters please check with Dynojet before installation. For technical assistance contact your Dynojet distributor or call Dynojet U.S.A. (800)-992-4993

2191 Mendenhall Dr. Suite 105
 North Las Vegas, NV 89031
 TEL: 702-399-1423
 FAX: 702-399-1431
 8am-5pm Pacific Time
 Monday through Friday

Website Address
<http://www.dynojet.com>

The manufacturer and seller make no warranties express or implied which extend beyond the description of the goods contained herein. Any description of this product is for the purpose of identifying it and shall not be deemed to create an express warranty.



E2151.001

European Models Only

1993-95 Kawasaki ZZR1100

Stage 1

For mildly tuned machines using the stock air-box, with stock or K&N filter. May also be used with a good aftermarket exhaust system
 K&N filter #KA-0010

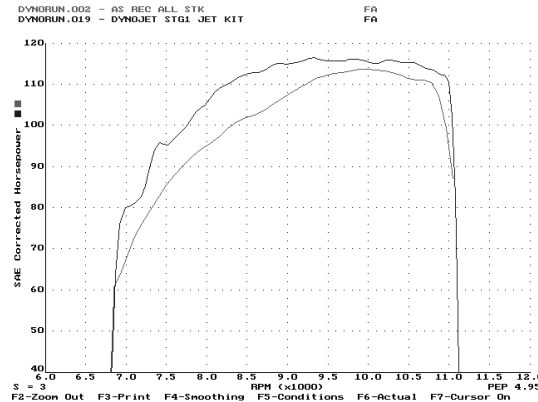

This graph shows a typical gain with a Dynojet jet kit.

WARNING

**NO SMOKING!
 NO OPEN FLAME!
 WHILE INSTALLING
 YOUR DYNOJET KIT**

Parts List

4	Main Jets	DJ155
4	Main Jets	DJ160
4	Main Jets	DJ165
4	Fuel Needles	DNO233
4	E-Clips	DE0001
8	Adjusting Washers	DW0001
1	Slide Drill	DD #39

STAGE ONE INSTRUCTIONS

1. Remove vacuum slides from carbs. Remove stock needles and spacers, noting order of assembly (Fig.B)
2. Using the drill bit provided (DD #39) drill an auxiliary slide lift hole in the position shown in Fig. A. Enlarging the stock slide lift holes did not produce any gains in performance. By drilling this auxiliary hole you will get the optimum performance out of this kit. If for any reason you need to go back to stock use JB weld or a similar product to fill up this hole.
3. Install Dynojet needles on groove #2 from the top. Use all stock spacers. Install the small Dynojet washers above the E-clip (2 per needle). After installing the slides in the carbs be sure to check slide movement manually.
4. Remove the stock main jets and replace with Dynojet main jets provided. If you are running the stock exhaust install the DJ160 main jets. If you are running an aftermarket exhaust or slip-on with high flowing baffle use the DJ165 main jets. Be sure that the jet you are changing is the main jet.
5. Locate the fuel mixture screw (Fig. D). Carefully turn the mixture screws clockwise until lightly seated, then back out 3 turns.

DYNOJET
E2151.001

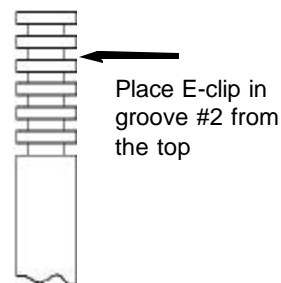
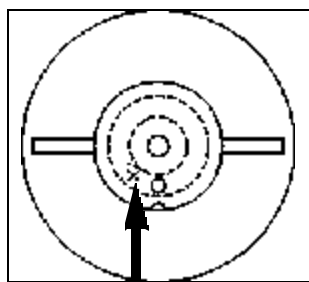

Fig. A



Auxiliary Slide Lift Hole Location

Fig. B

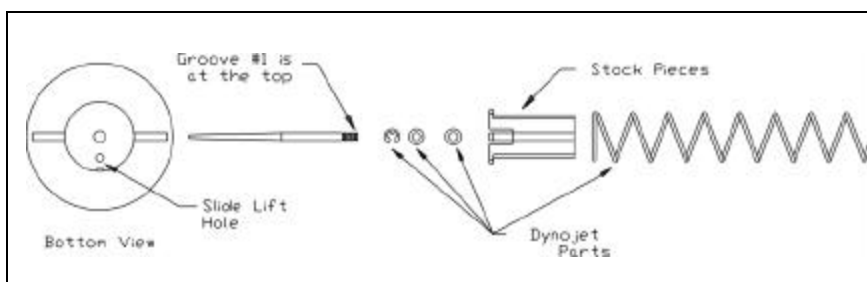

Fig. C

