

Thank you for purchasing this Dynojet kit. This kit has been developed for a motorcycle which is set to the parameters listed at the right in the "Stage" description. If your motorcycle does not meet any of these parameters please check with Dynojet before installation. For technical assistance contact your Dynojet distributor or call Dynojet U.S.A. (800)-992-4993

2191 Mendenhall Dr. Suite 105  
 North Las Vegas, NV 89031  
 TEL: 702-399-1423  
 FAX: 702-399-1431  
 8am-5pm Pacific Time  
 Monday through Friday

Website Address  
<http://www.dynojet.com>

The manufacturer and seller make no warranties express or implied which extend beyond the description of the goods contained herein. Any description of this product is for the purpose of identifying it and shall not be deemed to create an express warranty.



**E2157.001**

European Models Only

*1995-98 Kawasaki GPZ 1100*

**Stage 1**

For mildly tuned machines using the stock air-box, with stock or K&N filter. May also be used with a good aftermarket exhaust system  
 K&N filter #N/A

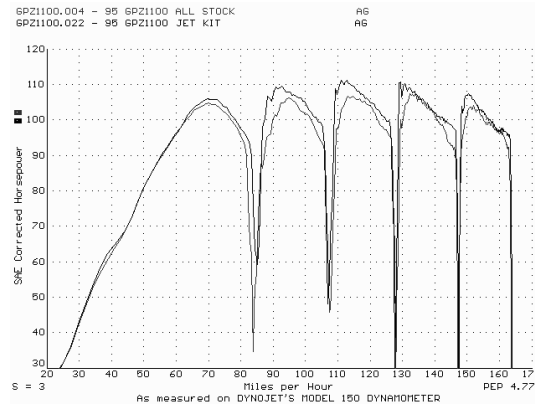

*This graph shows a typical gain with a Dynojet jet kit.*

# WARNING

**NO SMOKING!  
 NO OPEN FLAME!  
 WHILE INSTALLING  
 YOUR DYNOJET KIT**

## Parts List

4	Main Jets	DJ104
4	Main Jets	DJ108
4	Fuel Needles	DNO208
8	Adjusting Washers	DW0001
4	E-clips	DE0001
4	Slide Springs	DSP005

## STAGE ONE INSTRUCTIONS

1. Remove the vacuum slide from the carbs. Remove the stock needles & spacers, noting order of assembly.
2. Install Dynojet needles on groove #2, using all stock spacers. Install the Dynojet washers above the E-clip (2 per needle). Make sure that the needle retainer is installed exposing the slide lift hole and securing the needle in place.
3. Install Dynojet slide springs (DSP005) in place of the stock springs.
4. Remove the stock main jets and replace with the Dynojet mains provided. Use the DJ104 main jets for stock exhaust, and use the DJ108 main jets for aftermarket exhaust systems. Be sure that the jets you are changing are the main jets.
5. Locate the fuel mixture screw (Fig. B), carefully turn mixture screws clockwise until lightly seated, then turn out until you find your best idle. Our base setting is 2-1/2 turns.

**DYNOJET**  
E2157.001

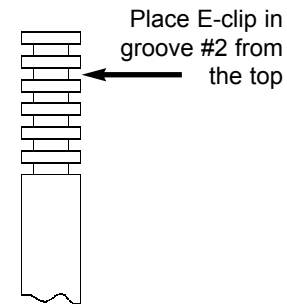

Fig. A

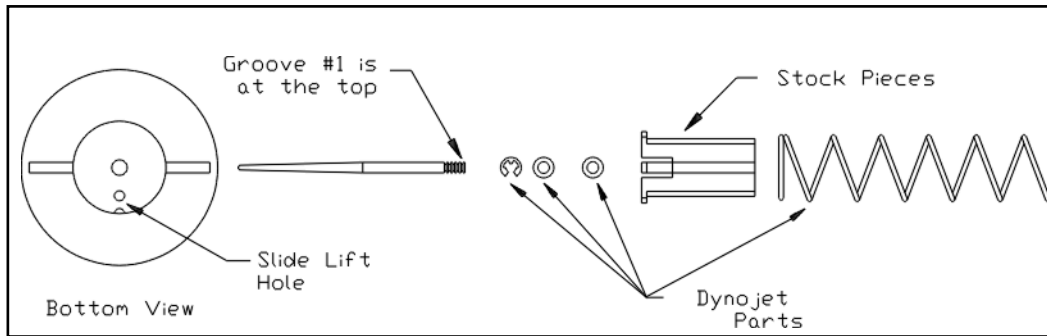
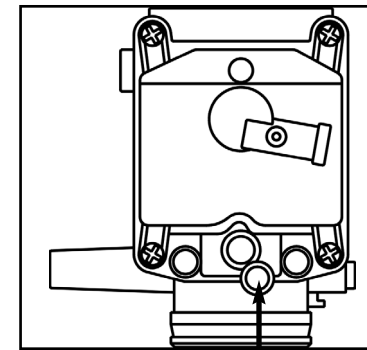

Fig. B



Fuel Mixture Screw