

Thank you for purchasing this Dynojet kit. This kit has been developed for a motorcycle which is set to the parameters listed at the right in the "Stage" description. If your motorcycle does not meet any of these parameters please check with Dynojet before installation. For technical assistance contact your Dynojet distributor or call Dynojet U.S.A. (800)-992-4993

2191 Mendenhall Dr. Suite 105
 North Las Vegas, NV 89031
 TEL: 702-399-1423
 FAX: 702-399-1431
 8am-5pm Pacific Time
 Monday through Friday

Website Address
<http://www.dynojet.com>

The manufacturer and seller make no warranties express or implied which extend beyond the description of the goods contained herein. Any description of this product is for the purpose of identifying it and shall not be deemed to create an express warranty.



E2159.002

European Models Only

1995-97 Kawasaki ZX6R

Stage 1

For mildly tuned machines using the stock air-box, with stock or K&N filter. May also be used with a good aftermarket exhaust system
 K&N filter #KA-0014

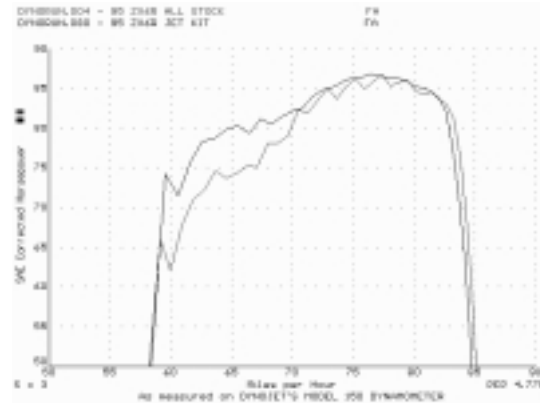

This graph shows a typical gain with a Dynojet jet kit.

WARNING

**NO SMOKING!
 NO OPEN FLAME!
 WHILE INSTALLING
 YOUR DYNOJET KIT**

WARNING:
*THIS KIT IS NOT DESIGNED FOR
 USE WITH NON DIVIDER PLATE
 EXHAUST SYSTEMS*

Parts List

4	Main Jets	DJ118
4	Main Jets	DJ122
4	Fuel Needles	DNO119
4	E-Clips	DE0001
8	Adjusting Washers	DW0001
4	Main Air jet Plugs	DCO200
1	Tool	DT001
1	Glue	DA0001

STAGE ONE INSTRUCTIONS

1. Remove vacuum slides from carbs. Remove stock needles and spacers, noting order of assembly (Fig.A)
2. Install Dynojet needles on groove #4 from the top. Use all stock spacers (Fig. A). Install the small dynojet washers above the E-clip (2 per needle).
3. Remove the stock main jets and replace with Dynojet main jets provided. If you are running the stock exhaust install the DJ118 main jets. If you are running an aftermarket exhaust or slip-on with high flowing baffle use the DJ122 main jets. Be sure that the jet you are changing is the main jet.
4. Locate the main air passage (Fig. B). With the flat end facing into the carb, install the main air correctors provided (DCO200). With the glue provided lightly touch a dab on the outer edge of the air corrector. Use the tool provided (DT001) to tap lightly in place. Allow the glue to dry.
5. Locate the fuel mixture screw (Fig. C). Carefully turn the mixture screws clockwise until lightly seated, then back out 3 turns.

DYNOJET

E2159.002

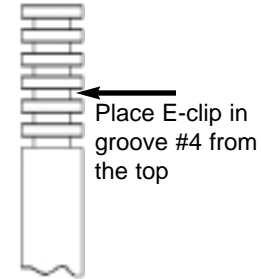

Fig. A

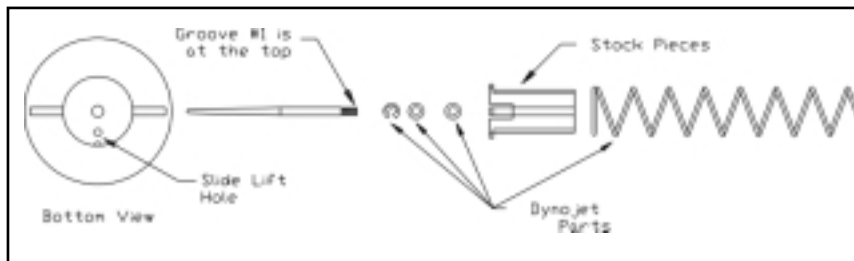

Fig. B

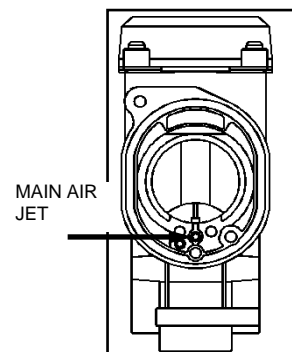

Fig. C

