

Thank you for purchasing this Dynojet kit. This kit has been developed for a motorcycle which is set to the parameters listed at the right in the "Stage" description. If your motorcycle does not meet any of these parameters please check with Dynojet before installation. For technical assistance contact your Dynojet distributor or call Dynojet U.S.A. (800)-992-4993

2191 Mendenhall Dr. Suite 105
 North Las Vegas, NV 89031
 TEL: 702-399-1423
 FAX: 702-399-1431
 8am-5pm Pacific Time
 Monday through Friday

Website Address
<http://www.dynojet.com>

The manufacturer and seller make no warranties express or implied which extend beyond the description of the goods contained herein. Any description of this product is for the purpose of identifying it and shall not be deemed to create an express warranty.



E3149.003

European Models Only

1996-97 Suzuki GSXR 750

Stage 1

For mildly tuned machines using the stock air-box, with stock or K&N filter. May also be used with a good aftermarket exhaust system
 K&N filter #SU-0005

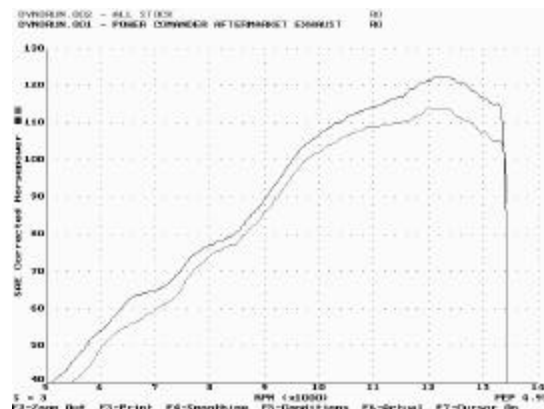

This graph shows a typical gain with a Dynojet jet kit.

WARNING

**NO SMOKING!
 NO OPEN FLAME!
 WHILE INSTALLING
 YOUR DYNOJET KIT**

Parts List

4	Main Jets	DJ128
4	Main Jets	DJ130
4	Main Jets	DJ132
4	Main Jets	DJ134
4	Fuel Needles	DNO704
4	E-Clips	DE0001
4	Adjusting Washers	DW0001
1	Slide Drill	DD #49

STAGE ONE INSTRUCTIONS

DYNOJET
E3149.003

1. Remove vacuum slides from carbs. Remove stock needles and spacers, noting order of assembly (Fig. A). Using the DD #49 drill bit provided, drill only the small slide lift hole (Fig. A). **Do not** drill the needle hole or the larger slide lift hole.
2. Install Dynojet needles on groove #3 from the top. Use all stock spacers (Fig. A). The small Dynojet washers are for half step increments and do not have to be installed at this time. After installing the slides in the carbs be sure to check slide movement manually before air box installation.
3. Install the Dynojet main jets provided. If you are running the stock exhaust install the DJ130 main jets in the outside cylinders (1&4) and the DJ128 main jets in the inner cylinders (1&4). If you are running an aftermarket exhaust or slip-on with a high flowing baffle, use the DJ132 main jets in the outside cylinders (1&4) and DJ130 main jets in the inner cylinders (2&3). If you are using an aftermarket exhaust and a K&N filter use the DJ134 main jets in the outside cylinders (1&4) and the DJ132 main jets in the inner cylinders (2&3). Be sure that the jets you are changing are the main jets.
4. Locate the fuel mixture screw (Fig. B). Carefully turn mixture screws clockwise until lightly seated, then back out 2 turns.

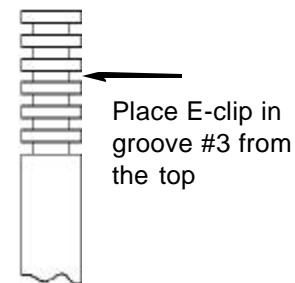

Fig. A

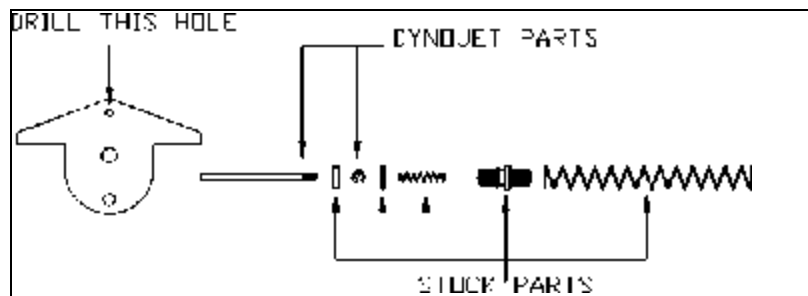

Fig. B

